

SUBJECT: ACCEPTANCE OF PROJECT – NEWCOMB STREET AND BEVERLY STREET SHOULDER STABILIZATION

SOURCE: Public Works Department - Engineering Division

COMMENT: Central Valley Asphalt has completed the Newcomb Street and Beverly Street Shoulder Stabilization Project per plans and specifications. The project included the installation of curb and gutter, sidewalk, driveways, asphalt concrete paving, storm drain pipe and catch basins, and other appurtenant construction along Newcomb Street and Beverly Street between Roby Avenue and Date Avenue.

Staff carefully tracks construction costs of all Capital Improvements Projects and reports project construction expenditures when the project is accepted by the City Council. On August 7, 2012, City Council authorized expenditure of \$858,362.72 for construction, construction management and quality control services for the Newcomb Street and Beverly Street Shoulder Stabilization Project. The following itemizes the construction-related costs in two categories: 1) the construction contract, and 2) a combination of construction management and quality control.

- 1) Final construction cost is \$731,599.05.
- 2) Construction management and quality control costs are \$55,662.77.

Total project construction costs equate to \$787,261.82, which is less than the \$858,632.72 overall budget approved by Council at the time of award.

Funding for this project is from Surface Transportation Program (STP), Congestion Mitigation Air Quality (CMAQ) funds and Proposition 1B funds and was approved in the 2012/2013 Annual Budget.

Central Valley Asphalt requests that the City accept the project as complete. Staff reviewed the work and found it acceptable.

RECOMMENDATION: That City Council:

1. Accept the project as complete;
2. Authorize the filing of the Notice of Completion; and
3. Authorize the immediate release of final payment, provided no stop notices have been filed.

ATTACHMENT: Locator Maps

Dir BGR Appropriated/Funded MB CM J

Item No. 5

NEWCOMB STREET

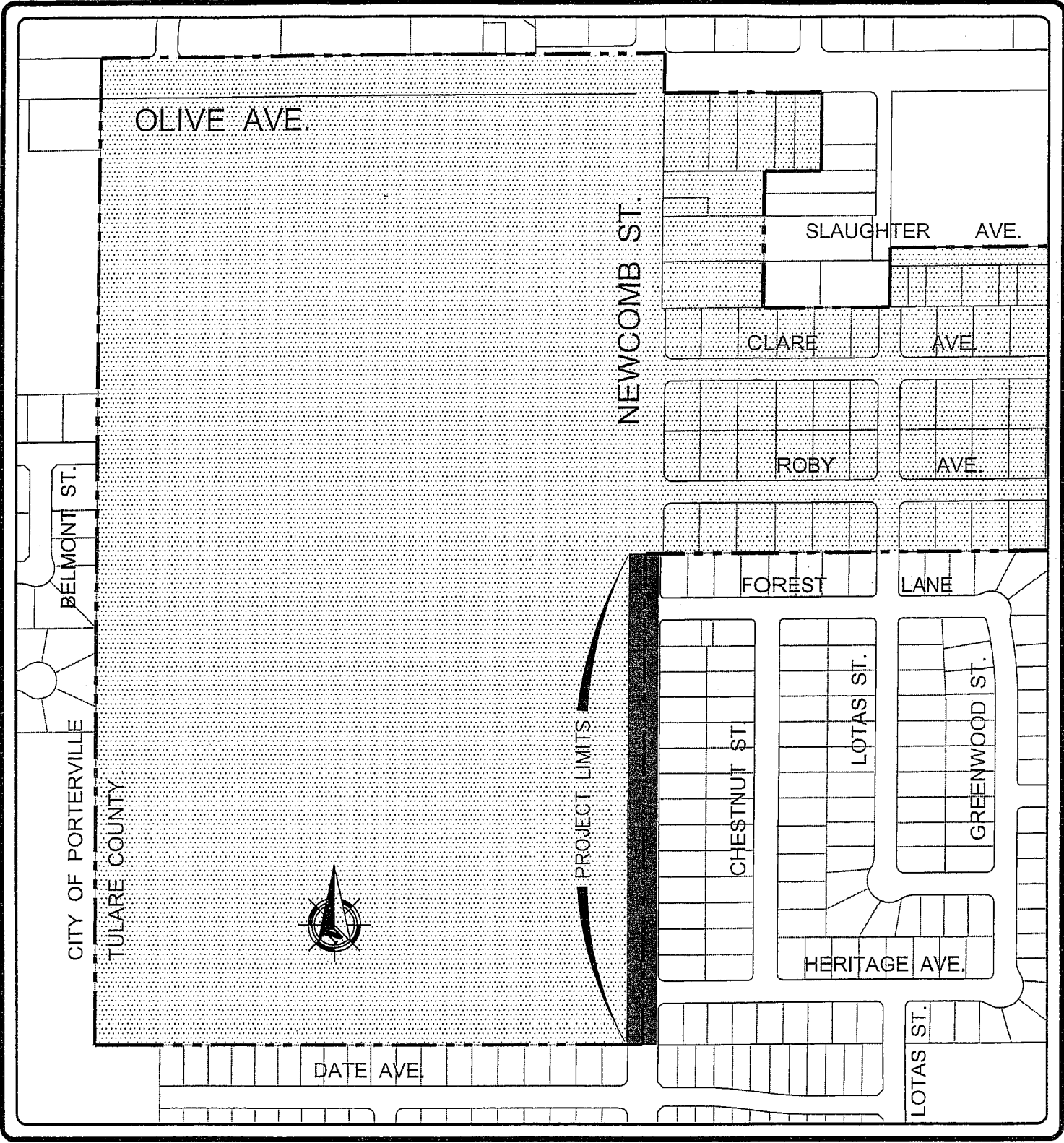

PROJECT LOCATION MAP

BEVERLY STREET

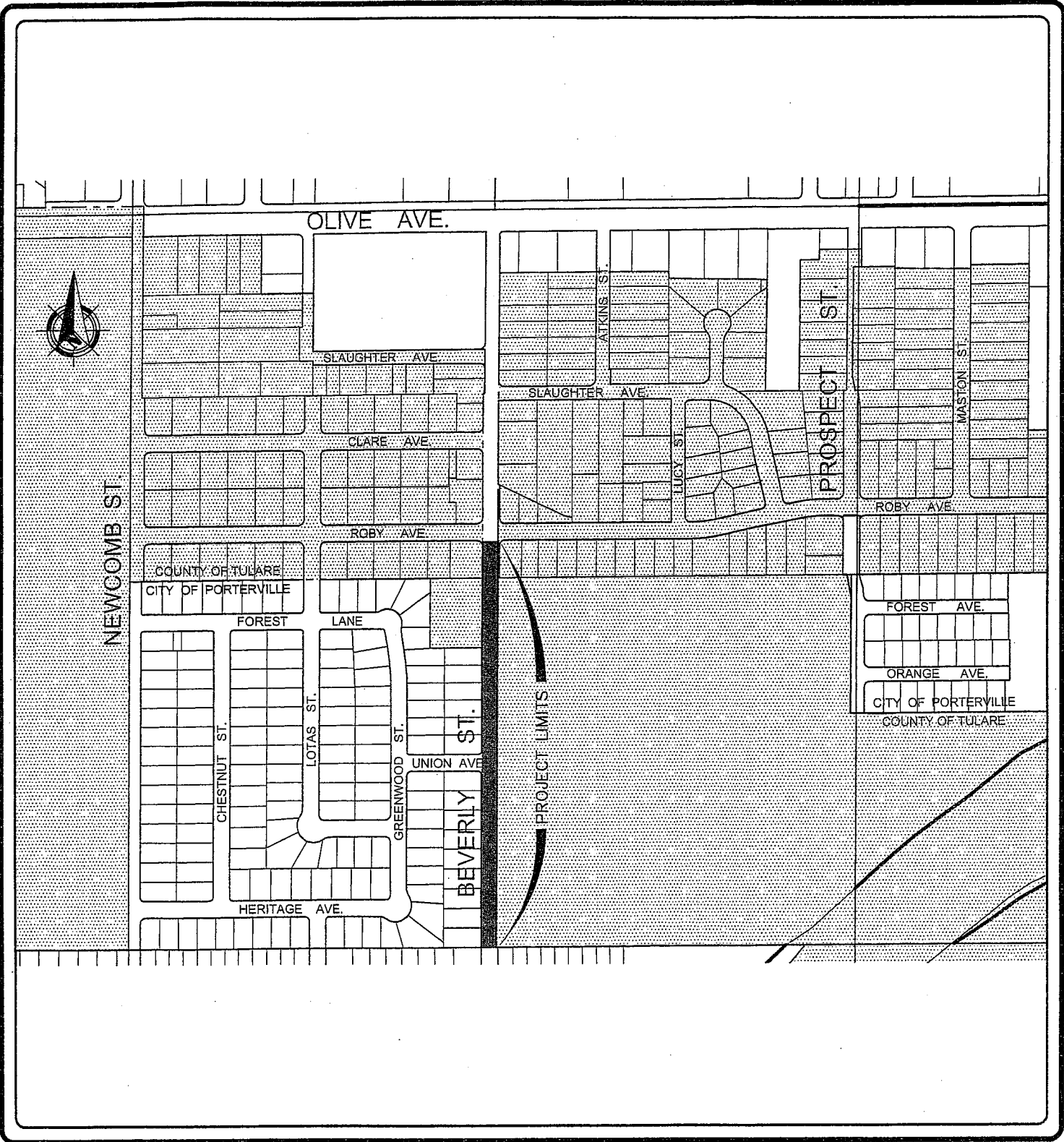

PROJECT LOCATION MAP